

BENOIT SYSTEMES



MOBILI KIT

MANUAL FOR INSTALLATION
& USE



← Follow us!

WWW.BENOITSYSTEMES.COM

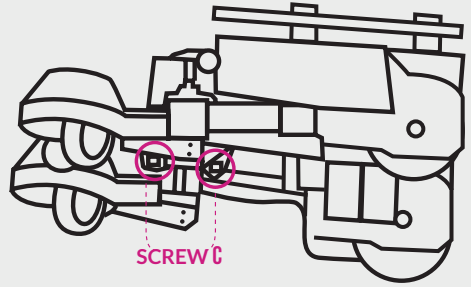
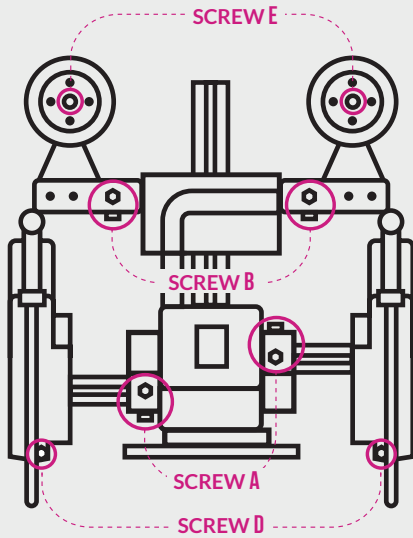

1 FIT THE FOOTRESTS

1. Remove the equipment from its packaging.
2. Remove the cover by unscrewing the three knobs.
3. Slightly loosen the 4 screws A.
4. Move the front wheels apart at least as far as mark H without going past the red area.
5. Hold the footrests vertically while fitting them onto the support bar, then allow them to slide as far as the stop.
Always keep one hand underneath the footrests.

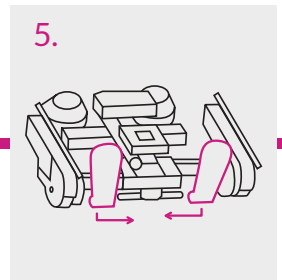
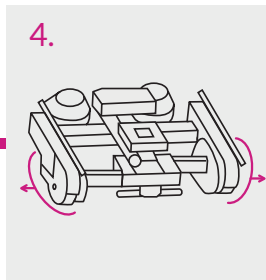
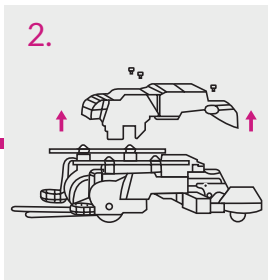

2 FIT THE FRONT AND REAR CHAIR BRACKETS

1. Open the box of accessories and take out the front and rear chair brackets.
2. Measure the chair using a tape measure and position the front and rear brackets based on the chair's dimensions.
3. Unscrew the 2 screws D, then fix the front chair brackets with these 2 screws. You can fit them in two different ways, depending on the chair chosen.
4. Fit the rear chair brackets using the 2 screws E, without tightening them.

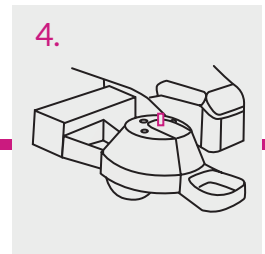
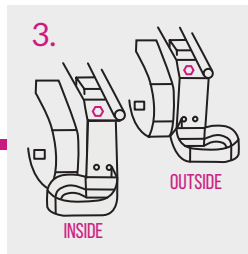
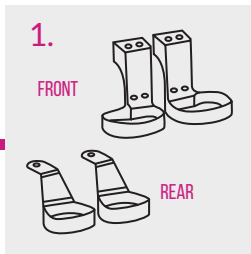

3 FIT THE BATTERY UNIT

1. Place the battery at the entry to the battery holder.
2. Slide it in using the rails and push the unit quite firmly until you hear the sound of the connectors engaging.

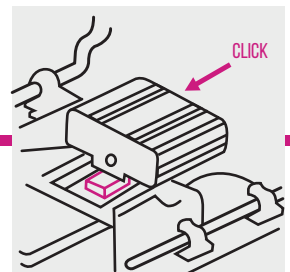

4 ADJUST THE PLATFORM

1. Lift the footrests and slide the adjusting block under the footrest support bar (non-slip surface uppermost).
2. Connect the control unit then switch on the equipment.
3. Select the 'jack' function then push the joystick forwards until it stops moving: the equipment is raised.
4. Switch off the equipment, then disconnect the control unit.
5. Adjust the spacing of the front wheels to suit the chair chosen.
6. Unscrew the 4 screws B and 2 screws C.
7. Adjust the depth and width of the rear set to suit the chosen chair and tighten the 2 screws E.
You must ensure that the equipment is as compact as possible to ensure it takes up the minimum of space.
8. Tighten the 2 screws C.
9. Reconnect the control unit.
10. Switch on the equipment again, select the 'jack' function and push the joystick backwards until it stops moving: the equipment is lowered.
11. Switch off the equipment again.
12. Disconnect the control unit.
13. Remove the adjusting block.
14. Lower the footrests.
15. Remove the battery unit: pull horizontally on the handle of the battery unit.
16. Tighten the 4 screws A and 4 screws B.
17. Refit the protective cover and tighten the 3 knobs.
Remember to release the elastic of the battery unit while replacing the protective cover.
18. Refit the battery unit, position the elastic using the ring to pass it over the screw head placed on the battery unit.

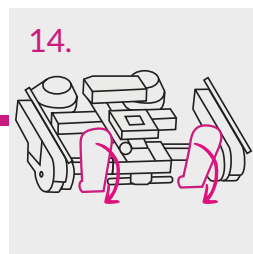
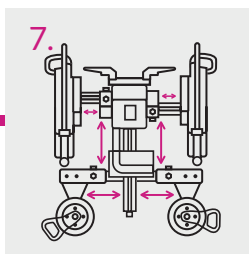
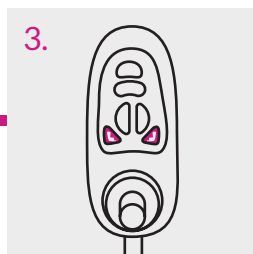

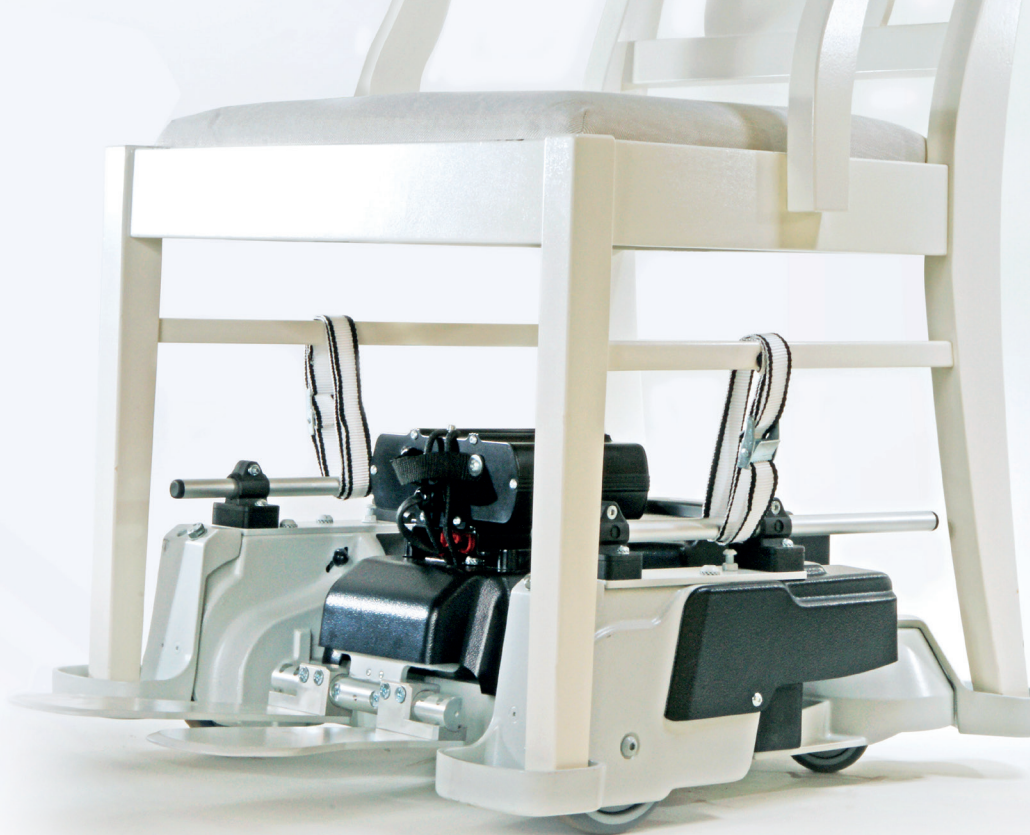

5 FIT THE CHAIR

1. Place the chair on the equipment.
2. Swivel the rear chair brackets to adjust their position and lock the chair in place, then tighten the 2 screws E.
3. Check the chair is stable. A strap kit to secure the chair is supplied.

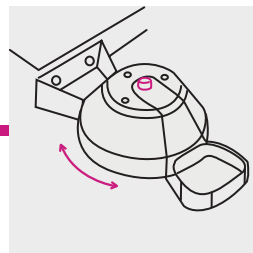

6

FIT THE CONTROL UNIT AND RETRACT FUNCTION

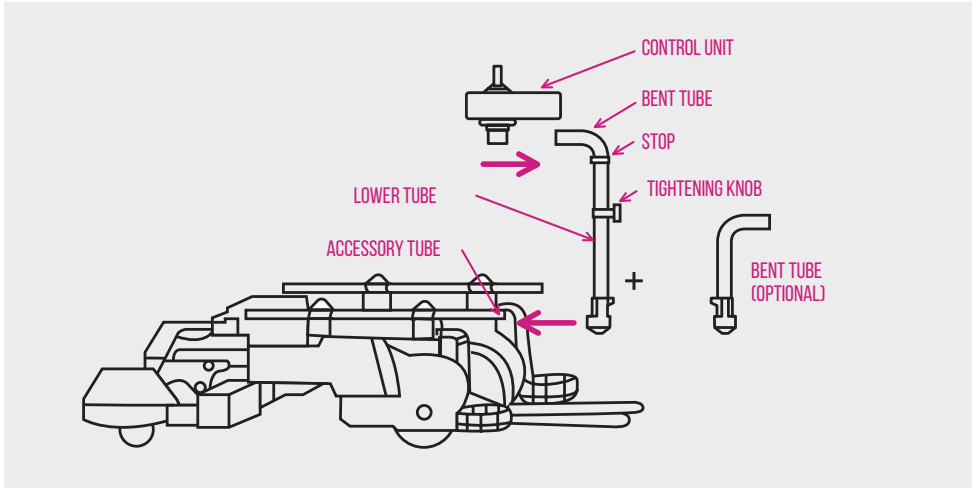

1. Loosen the screws of the accessory tube.
2. Move the tube backwards or forwards by the desired distance.
3. Tighten the screws.
4. There are 2 ways to fit the control unit:
 - a / Position 1: adjust the height of the control unit using the stop.
 - b / Position 2 for the retract function: adjust the 2nd bent tube and you can loosen the knob to swivel the unit.
5. Tighten the knob to position the unit.
6. Secure the unit's cable using the Velcro® strip provided.

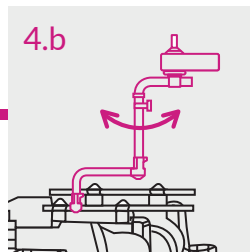
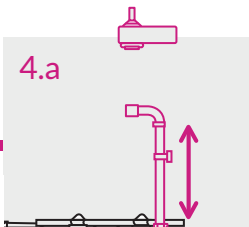



7 ADJUST WIDTH OF FOOTRESTS

Hold the footrests vertically and slide them along the support bar to the preferred notch (3 possible positions), then lower them

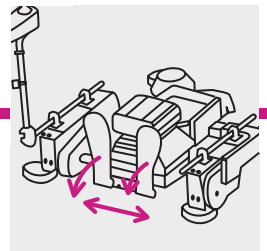





8 GETTING INTO THE CHAIR

1. To lower the footrests to the floor:
 - a/ Switch on the control unit
 - b/ Select the 'jack' function
 - c/ Push the joystick forwards to lower the footrests
 - d/ If you push the joystick for longer, the rear of the equipment is raised. You can stop this movement at any time by releasing the joystick. This 2nd position makes it easier for you to sit on the chair.
2. Sit down on the chair.
3. Push the joystick backwards: The equipment returns to its initial position and the footrests rise back to the desired height.

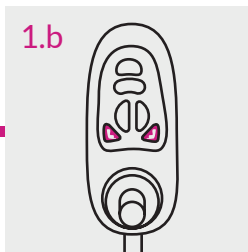

9 USING THE MOBILI KIT

1. Select the speed.
2. Move using the joystick: forwards to go forward, backwards to reverse, right to turn right and left to turn left.

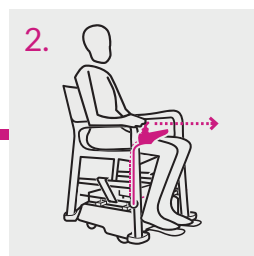
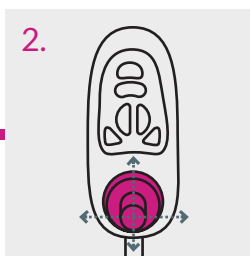
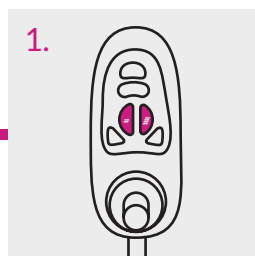

10 CHARGING THE BATTERY

If the battery is on the motor unit, clip the cylindrical part of the charger under the control unit. Then plug the charger into the mains power. Unplug once charging is finished (the charger LED goes green).

If the battery is not on the motor unit, clip the 2 red connectors together (charger and battery). Then plug the charger into the mains power. Unplug once charging is finished (the charger LED goes green).

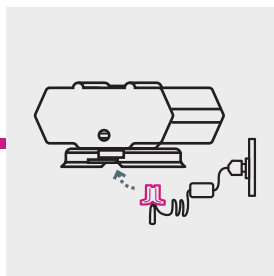
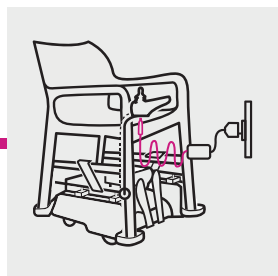

Pain aux noisettes

INGRÉDIENTS

- 250 g de farine de blé T 150
- 25 g de levure de boulanger
- 100 g de noisettes
- 50 g de cerneaux de noix
- 1 cuillère à soupe de miel de châtaigner
- 5 g de sel
- 25 cl d'eau tiède

RECETTE

Broyez rapidement les noix et les noisettes. Faites-les chauffer dans une casserole avec le lait d'amandes. Laissez infuser 1 heure,

ajoutez le miel. Mélangez au robot la farine, le sucre, le sel. Ajoutez le mélange de noix. Pressez bien à vitesse lente en ajoutant l'eau petit à petit. Couvrez et laissez lever 2 heures à température ambiante. Pétrissez une nouvelle fois et formez une boule. Déposez le pain dans un moule rectangulaire beurré et laissez lever encore 2 heures. Prechauffez le four au maximum, feitez le pain, enfournez dans un moule à découper. Démoulez et laissez refroidir sur une



CONSULT THE MAINTENANCE MANUAL

for instructions on operation, safety
and maintenance



Graphic design: EcololINK - June 2022

📍 7 Rue du Pont, 21450 Billy-lès-Chanceaux, France
☎ +33 (0)3 80 96 54 65 | @ export@benoitsystemes.com